

Easy Wood Plans

#78_231627AVE NE
Calgary, Alberta
Canada T2E 7A7

NOTICE
The purchaser agrees when purchasing this plan (the "Plan");
1) the purchaser has acquired the right to build or construct the object or project set out in the Plan (the "Project") for his/her/his personal use only and not for any commercial use, of the Plan in whole or in part;
2) reproduction reasons whatsoever is strictly prohibited;
3) Easy Wood Plans shall not be liable for any willful misuse or negligent use of this plan, the Project or any tools used to construct the Project or for any loss or damage resulting therefrom."

NOTE: Read all directions before beginning

- Carpenter's glue should be used to reinforce all joints
- Set all nails and countersink screws - use wood filler as necessary to spot nails and screws before finishing wood
- Dimensions shown in brackets denote millimetres
- Wipe off excess glue with a wet cloth before it has time to set

Directions:

Procedure 1) - See Figure 1

Begin your project by laying out all materials as illustrated in Figure 1 (Material Layout). Using a pencil, measuring tape and straightedge, (along with a protector, compass or miter gauge if preferred) draw out all the dimensions of the pieces and their dimensions and shapes illustrated in Figure 2 (Cutting Diagram). Be sure to include the part number designation for each piece as well. The dots in pieces B may be made using a dodd blade or using multiple cross cuts, on your table saw. If you don't have a jig saw or band saw, the curved areas can be cut with a coping saw or merely cut straight with a table or hand saw, and sanded to final shape.

The angles on pieces D & H are important, as any change in these will affect the fit of other pieces as well as the angle of the seat back. The large 24" radius arc that forms the curve of the seat and the large 24" radius arc that forms the curve of the backrest are important. The angles of the seat and backrest are included as precisely as possible using the dimensions as illustrated in the Cutting Diagram.

Due to the complexity and number of various pieces, and as this is an outdoor item, we recommend finishing with stain or oil prior to assembling the project.

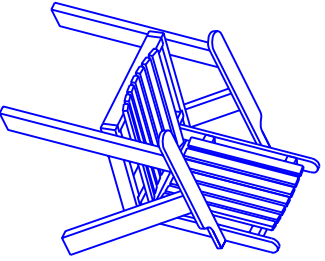

**PATIO/LAWN CHAIR
COMPLETED PROJECT**

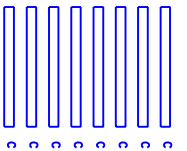
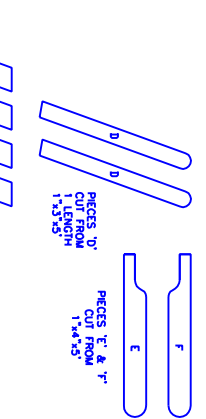
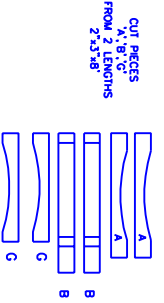

**MATERIALS LAYOUT
FIGURE 1**

**LESS CUT FROM 2 LENGTHS
2x4x8**

**PIECES 'C': CUT FROM
4 LENGTHS OF
1x2x8"**

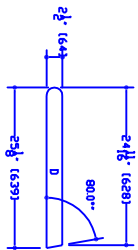
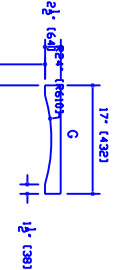
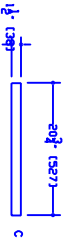
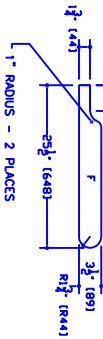
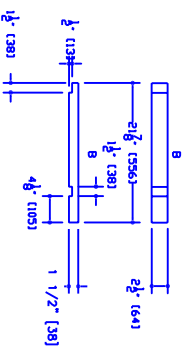
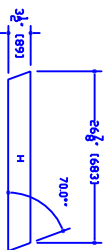
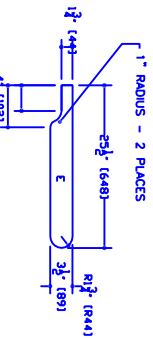
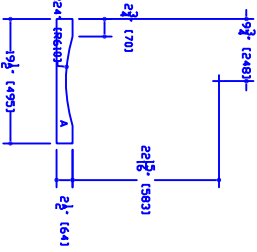

**CUTTING DIAGRAM
FIGURE 2**

MATERIAL LIST

- Two 2x4x8' (Cedar or Redwood)
- Two 2x4x8' (Cedar or Redwood)
- One 1x4x5' (Cedar or Redwood)
- One 1x4x5' (Cedar or Redwood)
- Four 1x2x8' (Cedar or Redwood)

MATERIAL LIST

- Approx. 100 1-1/2" #10 Flathead Screws
- Approx. 50 2-1/2" #10 Flathead Screws
- Sandpaper
- Carpenter's Glue
- Oil or Stain

TOOLS

- Table Saw and Jigsaw
- Panel, Drill and Square
- Power Drill and Protector
- 5/64" J/32" 7/64" drill bits
- Hammer and Screwdrivers
- Paint Brush and Putty Knife
- Power Sander (optional)